

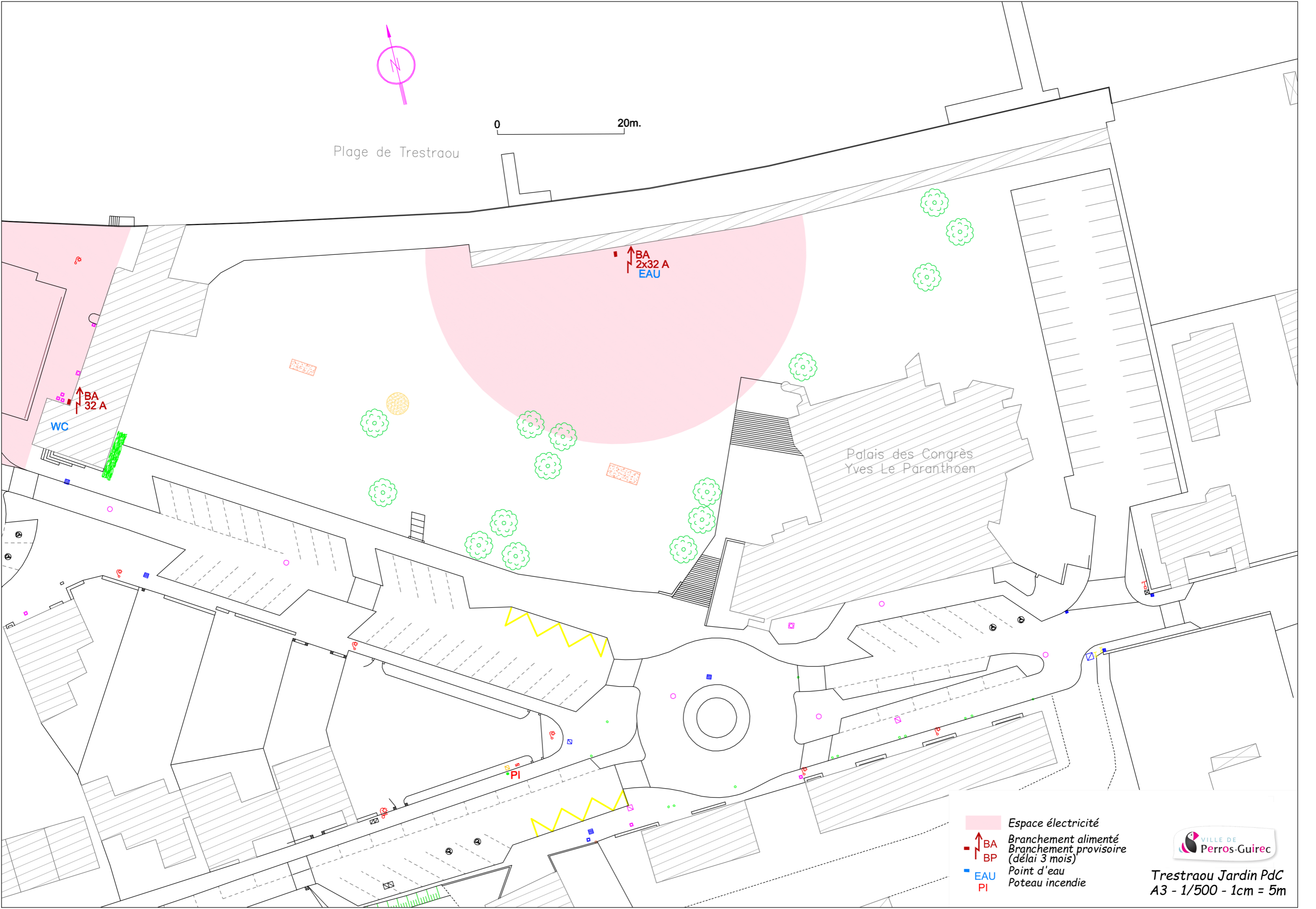

0 20m.

Plage de Trestraou







BA
2x32 A
EAU

BA
32 A

WC

Palais des Congrès
Yves Le Paranthoen

PI

-  Espace électricité
 -  BA
 -  BP
 -  EAU
 -  PI
- Branchement alimenté
Branchement provisoire
(délai 3 mois)
Point d'eau
Poteau incendie



Trestraou Jardin PdC
A3 - 1/500 - 1cm = 5m